

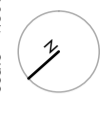







This drawing is the property of GWP Architecture. Copyright is reserved by them and the drawing is to be used for the project only. It is not to be reproduced, stored in a retrieval system, or transmitted in any form or by any means, electronic, mechanical, photocopying, recording, or by any information storage and retrieval system, without the consent in writing of GWP Architecture. PARTIAL RELEASE OF INFORMATION: This drawing is a preliminary design and is not to be used for construction. It is the responsibility of the client to ensure that all necessary permissions and approvals are obtained before commencing any work or construction. All work to be carried out is in accordance with current Building Regulations. Do not scale off drawing. Do not take digital dimensions from this drawing. Any discrepancies to be reported to the Architect.



KEY

-  Proposed distillery footprint
-  Proposed shop and masterclass experience
-  Site Boundary
-  Grassed area
-  Private driveway / vehicle access
-  Existing Trees
-  New Proposed planting
-  Existing hedge rows

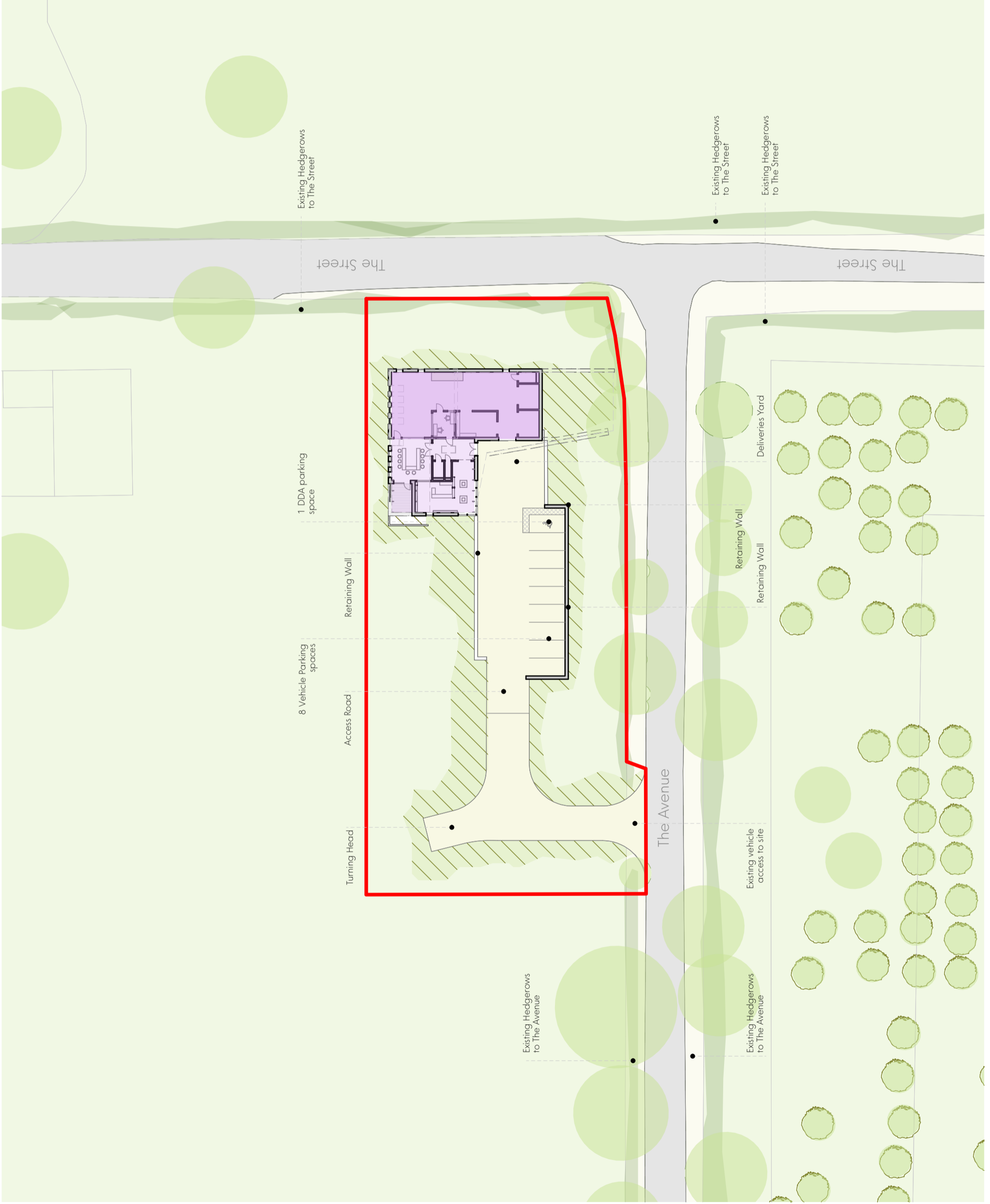

Rev	Date	Comment	Dr	Ch
P02	06.03.23	Distillery space layout update	JW	TA
P01	23.11.22	First Issue	JW	TA



CHARTERED ARCHITECTS
INTERIOR DESIGNERS
SCULPTURE DESIGNERS
PROJECT MANAGERS
LANDSCAPE ARCHITECTS

Buckden House, 148 West Lane, Leach, LE8 1PS
+44(0)1532 646444 (P) +44(0)113 248 3859 (F)
architecture@gwp-arch.com | www.gwp-arch.com
GWP Job Reference: (473)2122

Job Title: River Test Distillery
Client:

River Test Distillery



Name (473)2122-GWP-01-XX-DR-A-(PA)-0003

Scale	Revision	P02
1:500@A3		

Drawn/Checked	JW/TA	First Issue	23.11.22

Drawing Status: S2 - Planning

Z:\Users\GWP\CAD\4732122 - River Test Distillery\A-Architect\A-GWP\TA\Modell\4732122-GWP-01-XX-A-River Test Distillery - Hampshire-P02.dwg